



The Home Straight

You've come really far,
but there's still hard work to come.

You may be feeling tired,
but the finish is within reach.

Stay focused. Pace yourself.

You have prepared for this, and you
have a team of people behind you.

Two illustrations of a person climbing a mountain. In the first, the person is at the base and says 'WOW.'. In the second, the person is at the peak and says 'WOW.'.

YOU ARE
HERE

GCSE Exams Finish
Prom

@DECADEZDOODLES

Final Snapshot Report

- Published on Go4Schools on 27th March.
- Included Attributes, Estimated Grades, Revision Status and a Revision Comment

Subject	MTG	Current	Estimated	Quality of home learning	Behaviour for learning and participation	Quality of classwork	Quality of organisation	Revision Status
Dance	6	4 -	4 +	Good	Good	Good	Good	Targeted
Revision Comment Attend GCSE drop-in on a Wednesday or Friday lunch. Support for written work can be given during this time. Continue to revise the anthology works which are available on Satchel:One. Short revisions sessions where a mind-map/lists are revised about the different components is often the most effective revision. Spend time revising the AQA glossary and knowledge organiser. Students will also benefit from watching a range of choreography works in different genres on YouTube. This activity will develop the student's vocabulary within choreography work. <div>Mrs H Frost</div>								
English Language	7 -	6 +	6 +	Good	Outstanding	Outstanding	Good	Independent
Revision Comment will be encouraged to read through feedback and class notes from all learning this half term and action any areas of improvement suggested and targets given from the mocks and recent assessments in English Language. <div>Mrs E Merry</div>								
Geography	7 +	8 +	7 +	Session Attendance Information				Behaviour Information
Revision Comment Use the OCR B GCSE Geogr Use the resources on SMHV papers, OCR B GCSE Geogr notes and add more detail t sessions on Thursdays at lu				Percentage attendance: 93.23% Attendance: 234 Authorised absences: 17 Unauthorised absences: 0 Possible sessions: 251				Positive points: 38 Negative points: -4

The next 2 weeks after Easter...

- Two 'normal' weeks before the first exam (Drama).
- The curriculum continues.
- Intervention is ongoing, based on your final report.

+ 3 weeks

- Most subjects have their first exam before the half-term break.
- Your lesson timetable continues through these weeks.
- Lessons are well-placed to support your exam preparation.



	Form 8:30-8:50	Period 1 8.50 – 9.50	Period 2 9.50 – 10.50	Period 3 11.10 – 12.10	Period 4 1.00 – 2.00	Period 5 2.00 – 3.00	After School
Monday 21 st April Week 2		Easter Monday – School Closed					
	Form Time	Option B	English	Comb Sci + Triple	Maths	After School	
Tuesday 22 nd April		MFL Speaking Exams (Mrs Cherrier's French group, by appointment only)					
	Form Time	Option A	Option A	Maths	Option B	Comb Sci + PE	After School
Wednesday 23 rd April		MFL Speaking Exams (Miss Mayzes' French group, by appointment only)					
	Form Time	Comb Sci + Triple	Maths	Option C	Option C	English	After School
Thursday 24 th April	Art students set up	Art Exam Day 1 (all Art students) MFL Speaking Exams (Mrs Alforcea's Spanish group, by appointment only)					
	Form Time	Maths	Option D	Option C	English	Comb Sci + Triple + PSHE	After School
Friday 25 th April	Art students set up	Art Exam Day 2 (all Art students) MFL Speaking Exams (Mrs Keen's Spanish group, by appointment only)					Done: Art
	Form Time	Option A	Comb Sci + Triple + PSHE	Comb Sci + Triple + PSHE	Option D	PE + Triple + PSHE	After School

The first
week back

The second week back

	Form 8:30-8:50	Period 1 8.50 – 9.50	Period 2 9.50 – 10.50	Period 3 11.10 – 12.10	Period 4 1.00 – 2.00	Period 5 2.00 – 3.00	After School
Monday 28 th April Week 1		MFL Speaking Exams (Mrs Alforcea and Mrs Keen's Spanish groups, by appointment only)					
	Form Time	English	Option A	Comb Sci + Triple	Option C	Option B	After School
Tuesday 29 th April Week 1		GCSE PE Moderation (By appointment only)					
	Form Time	Comb Sci + Triple	PE + PSHE	English	Option C	Maths	After School
Wednesday 30 th April		Normal school day					
	Form Time	Option D	Option D	Comb Sci + Triple	Maths	English	After School
Thursday 1 st May		Drama Exam Day 1 (all Drama students)					
	Form Time	English	Comb Sci + Triple	Option B	Maths	Option D	After School
Friday 2 nd May		Drama Exam Day 2 (all Drama students)					Late finish (5pm)
	Form Time	Comb Sci + PE + PSHE	Option B	Comb Sci + Triple	PE + Triple	Option A	After School

1 st Week	Form 8:30-8:50	Period 1 8.50 – 9.50	Period 2 9.50 – 10.50	Period 3 11.10 – 12.10	Period 4 1.00 – 2.00	Period 5 2.00 – 3.00	After School
----------------------	-------------------	-------------------------	--------------------------	---------------------------	-------------------------	-------------------------	-----------------

The first Exams

Notice:

- Exams, in Yellow
- The focus of lessons, in blue
- Breakfast sessions, in pink

ms

Yellow
of lessons, in blue
sessions, in pink

		Bank Holiday – School Closed					
		Option B	English	Comb Sci + Triple	Maths	After School	
		Normal school day					
		Option A	Maths	Option B	Comb Sci + PE	After School	
		Normal school day					
	Form Time	Comb Sci + Triple	Maths	Option C	Option C	English	After School
Thursday 8 th May	Drama Breakfast	Drama: (23) 1hr 30mins 08:45 – 10:15		(no exams)			Done: Drama
		Turkish: (1) Higher Listening 45mins and Reading 1hr 5mins 08:45 – 10:35					
		Normal Lesson	Normal Lesson	Normal Lesson	Normal Lesson	Normal Lesson	
	Form Time	Maths	Option D	Option C	English	Comb Sci + Triple + PSHE	After School
Friday 9 th May		Normal school day					
		Normal Lesson	Normal Lesson	Normal Lesson	Normal Lesson	Normal Lesson	
	Form Time	Option A	Comb Sci + Triple + PSHE	Comb Sci + Triple + PSHE	Option D	PE + Triple + PSHE	After School

The first full week,
before half-term

2nd Week		Period 1 8.50 – 9.50	Period 2 9.50 – 10.50	Period 3 11.10 – 12.10	Period 4 1.00 – 2.00	Period 5 2.00 – 3.00	After School
		English Literature: Paper 1 (156) 1hr 45 mins 08:45 – 10:30		(no exam)	Computer Science: Paper 1 (20) 2hrs 13:00 – 15:00		Late finish for CS students with Extra Time
		Exam	Exam	Normal Lesson	His, Geog Revision / Normal	His, Geo Revision / Normal	
	Form Time	English	Option A	Comb Sci + Triple	Option C	Option B	After School
Tuesday 13 th May	RS Breakfast	Religious Studies: Paper 1 (9) 2hrs 08:45 – 10:45		(no exam)	Triple Science Biology: Paper 1 (59) 1hr 45mins 13:00 – 14:45 Combined Science Biology: Paper 1 (101) 1hr 15mins 13:00 – 14:15		Late finish for Triple Science students with Extra Time
		Normal Lesson	Biology Revision	Normal Lesson	Exam	Normal Lesson	
	Form Time	Comb Sci + Triple	PE + PSHE	English	Option C	Maths	After School
Wednesday 14 th May	Geography Breakfast	Geography: Paper 1 (95) 1hr 15 mins 08:45 – 10:00		(no exam)	(Yr9 Maths Paper 1)	(Yr9 Science Paper 1)	
		Normal Lesson	Normal Lesson	Normal Lesson	Normal Lesson	Normal Lesson	
	Form Time	Option D	Option D	Comb Sci + Triple	Maths	English	After School
Thursday 15 th May	Maths Breakfast	Mathematics: Paper 1 (non-calculator) (160) 1hr 30 mins 08:45 – 10:15		(no exam)	(Yr9 English Paper 1)	(Yr9 Maths Paper 2)	
		Exam	Normal Lesson	History, PE Revision / Normal	History Revision / Normal	History, CS Revision / Normal	
	Form Time	English	Comb Sci + Triple	Option B	Maths	Option D	After School
Friday 16 th May	History Breakfast	History: Paper 1 (82) 1hr 20 mins 08:45 – 10:05		(no exam)	(Yr9 Science Paper 2)	(Yr9 English Paper 2)	
		Science Lesson/Revision	Normal Lesson	Normal Lesson	Science Lesson / Revision	Normal Lesson	
	Form Time	Comb Sci + PE + PSHE	Option B	Comb Sci + Triple	PE + Triple	Option A	After School

The second full week,
before half-term

3 rd Week		Period 1 8.50 – 9.50	Period 2 9.50 – 10.50	Period 3 11.10 – 12.10	Period 4 1.00 – 2.00	Period 5 2.00 – 3.00	After School
Monday 19 th May	Form Time	Triple Science Chemistry: Paper 1 (59) 1hr 45mins 08:45 – 10:30 Combined Science Chemistry: Paper 1 (101) 1hr 15mins 08:45 – 10:00		(no exam)	Physical Education: Paper 1 (29) 1hr 13:30 – 14:30		
		Exam	Normal Lesson	Normal Lesson	Normal Lesson	CS, Fr, RS Revision / Normal	
	Form Time	Core PE + Triple	Option B	English	Comb Sci + Triple	Maths	After School
Tuesday 20 th May	English Literature Breakfast	English Literature: Paper 2 (157) 2hrs 15mins 08:45 – 11:00		(no exam)	Computer Science: Paper 2 (20) 1hr 45mins 13:00 – 14:45		Done: English Lit Computer Science Late finish for CS students with Extra Time
		Exam	Exam	Normal	French & RS Revision / Normal	Normal Lesson	
	Form Time	Option A	Option A	Maths	Option B	Comb Sci + PE	After School
Wednesday 21 st May	French Breakfast	French Reading (34) Foundation 45mins 08:45 – 09:30 Higher 1hr 08:45 – 09:45	French Listening (10) Foundation 35mins 10:15 – 10:50	French Listening (24) Higher 45mins 11:10 – 11:50	Religious Studies: Paper 2 (9) 2hrs 13:00 – 15:00		Done: Religious Studies Late finish for RS students with Extra Time
		Normal Lesson	Normal Lesson	Physics / RS Revision	Physics Revision / Exam	Normal Lesson	
	Form Time	Comb Sci + Triple	Maths	Option C	Option C	English	After School
Thursday 22 nd May	Physics Breakfast	Triple Science Physics: Paper 1 (59) 1hr 45 mins 08:45 – 10:30 Combined Science Physics: Paper 1 (101) 1hr 15mins 08:45 – 10:00		(no exam)	Sport Science (23) 1hr 15mins 13:00 – 14:15 Turkish: Writing (1) Higher 1hr 25mins 13:00 – 14:25		Done: Sport Science Turkish
		Exam	Sport Revision / Normal	Sport Revision / Normal	English Lesson	English Revision	
	Form Time	Maths	Option D	Option C	English	Comb Sci + Triple + PSHE	After School
Friday 23 rd May	English Language Breakfast	English Language: Paper 1 (160) 1hr 45mins 08:45 – 10:30		Leaver's Assembly	Leaver's Afternoon		
		Exam	Exam				
	Form Time	Option A	Comb Sci + Triple + PSHE	Comb Sci + Triple + PSHE	Option D	PE + Triple + PSHE	After School

The first week after half-term

4 th Week	Form 8:30-8:50	Period 1 8.50 – 9.50	Period 2 9.50 – 10.50	Period 3 11.10 – 12.10	Period 4 1.00 – 2.00	Period 5 2.00 – 3.00	After School
	Stats breakfast	Statistics: Paper 1 (57) 1hr 30mins 08:45 – 10:15		Japanese (1) Foundation Reading 50mins 10:30 – 11:20 Listening 35mins 11:30 – 12:05	Engineering: Written (20) 2hrs 13:00 – 15:00 Dance: Written (15) 1hr 30mins 13:00 – 14:30		Done: Engineering Dance <i>Late finish for Engin. students with Extra Time</i>
	Form Time	English	Option A	Comb Sci + Triple	Option C	Option B	After School
Tuesday 3 rd June		Russian (1) Reading 1hr 5mins 08:45 – 09:50 Higher Listening 45mins 10:00 – 10:45 (no exam)		(no exam)	Polish (1 Yr10 student) Higher Listening 45mins Reading 1hr 13:00 – 14:45		
	Form Time	Comb Sci + Triple	PE + PSHE	English	Option C	Maths	After School
Wednesday 4 th June	Maths Breakfast	Maths: Paper 2 (calculator) (160) 1hr 30mins 08:45 – 10:15		(no exam)	Health and Social Care (21) 1hr 15mins 13:00 – 14:15		Done: H&SC
	Form Time	Option D	Option D	Comb Sci + Triple	Maths	English	After School
Thursday 5 th June	History Breakfast	History: Paper 2 (82) 1hr 50mins 08:45 – 10:35		(no exam)	French: Writing (34) Foundation 1hr 13:00 -14:00 Higher 1hr 15mins 13:00 – 14:15		Done: French
	Form Time	English	Comb Sci + Triple	Option B	Maths	Option D	After School
Friday 6 th June	English Breakfast	English Language: Paper 2 (160) 1hr 45mins 08:45 – 10:30		(no exam)	Geography: Paper 2 (95) 1hr 15mins 13:00 – 14:15		Done: English Language
	Form Time	Comb Sci + PE + PSHE	Option B	Comb Sci + Triple	PE + Triple	Option A	After School

The second week after half-term

5 th Week	Form	Period 1 8.50 – 9.50	Period 2 9.50 – 10.50	Period 3 11.10 – 12.10	Period 4 1.00 – 2.00	Period 5 2.00 – 3.00	After School
< Enrichment Week >							
Week 2	Breakfast	Triple Science Biology: Paper 2 (59) 1hr 45mins 08:45 – 10:30 Combined Science Biology: Paper 2 (101) 1hr 15mins 08:45 – 10:00		(no exam)	Physical Education: Paper 2 (29) 1hr 13:30 – 14:30		Done: Biology PE
Tuesday 10 th June	Spanish Breakfast	Spanish Reading (42) Foundation 45mins 08:45 – 09:30 Higher 1hr 08:45 – 09:45	Spanish Listening (15) Foundation 35mins 10:15 – 10:50	Spanish Listening (27) Higher 45mins 11:10 – 11:55	Japanese: Writing (1) Foundation 1hr 20mins 13:00 – 14:20 History: Paper 3 (82) 1hr 30mins 13:00 – 14:30		Done: Japanese History
Wednesday 11 th June	Maths Breakfast	Maths: Paper 3 (calculator) (160) 1hr 30mins 08:45 – 10:15		(no exam)	Contingency Afternoon Be aware that any disrupted exam can be rescheduled for this afternoon.		Done: Maths
Thursday 12 th June	Geography Breakfast	Geography: Paper 3 (95) 1hr 30mins 08:45 – 10:15		(no exam)	Russian: Writing (1) Higher 1hr 25mins 13:00 – 14:25		Done: Geography Russian
Friday 13 th June	Chemistry Breakfast	Triple Science Chemistry: Paper 2 (59) 1hr 45mins 08:45 – 10:30 Combined Science Chemistry: Paper 2 (101) 1hr 15mins 08:45 – 10:00		(no exam)	Statistics: Paper 2 (57) 1hr 30mins 13:00 – 14:30 Polish: Writing (1 Yr10 student) Higher 1hr 15mins 13:00 – 14:15		Done: Chemistry Stats Polish

The full timetable is on the LVC website and Satchel:One.
You will also have your printed version.



SELECT LANGUAGE

Google Translate

SEARCH

Q



MENTAL HEALTH

SPORTS CENTRE

REMOTE ACCESS

HOME

ABOUT US

CURRICULUM

PARENTS

INFORMATION

NEWS AND EVENTS

QUICK LINKS

CONTACT

JOIN US



Yr11 GCSE Exams – Summer 2025

YEARS 10 AND 11

YR10 AND YR11 CALENDARS

KS4 COURSE OVERVIEWS

WELL-BEING SUPPORT

Please see the full GCSE exam timetable below. Students will receive a printed copy and a digital version is available [here](#).

The date of the final day of normal lessons will announced in the spring. Full details of how the exams will operate (including study base, exam leave arrangements and guided study intervention) will be published in June 2025.

Form	Period 1	Period 2	Period 3	Period 4	Period 5	After School
8.30-8.50	8.50 – 9.50	9.50 – 10.50	11.10 – 12.10	1.00 – 2.00	2.00 – 3.00	

The Study Base

Until half-term

The old reception area around the dining hall will be your study base.

Information Point

- Full exam timetable
- Seating plans for exams

Dining Hall

- Breakfast and lunch warm-up sessions

Entrance

- You *must* sign in here on days you have morning exams.

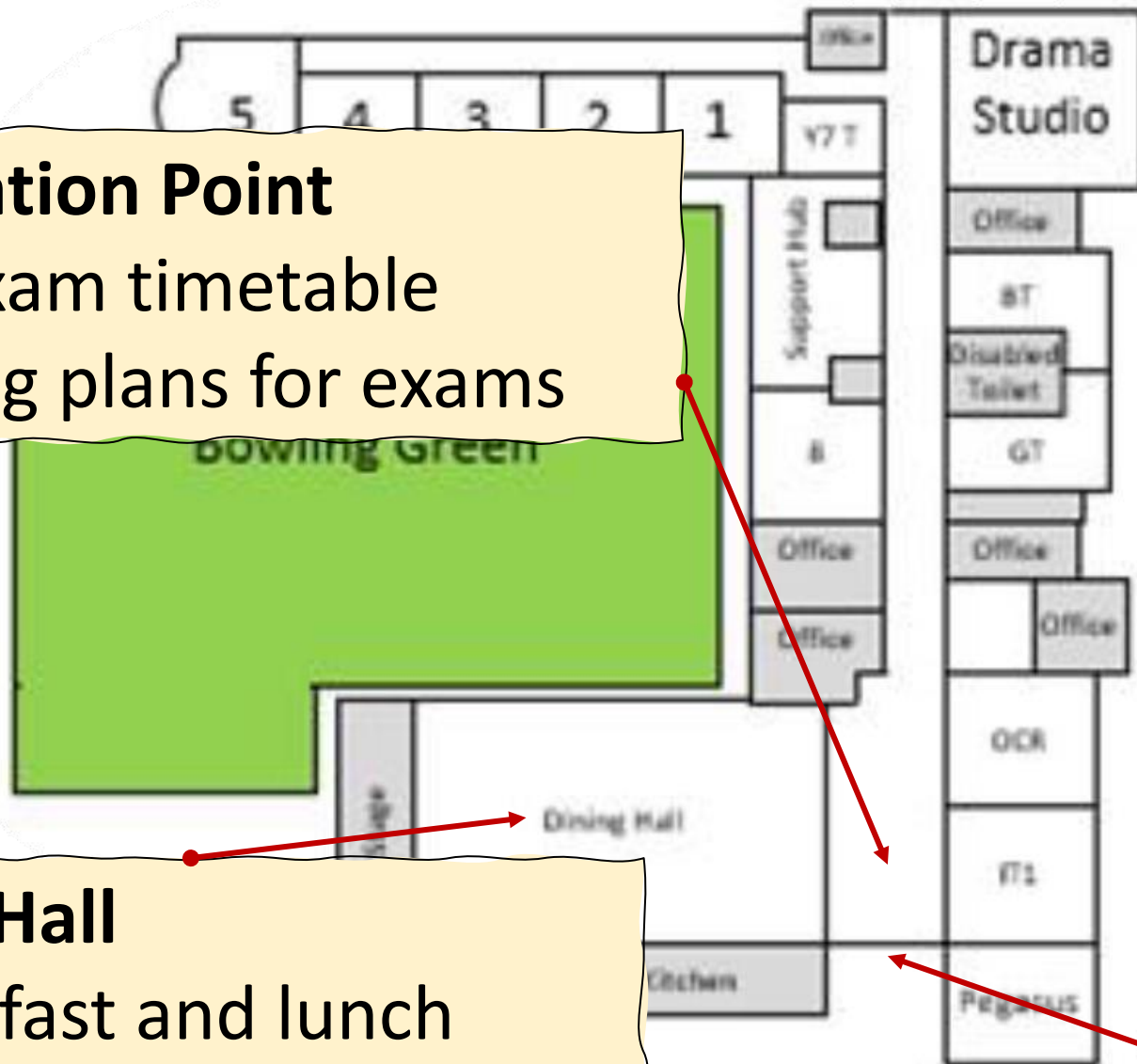

Exam Routines

Until half-term

Start in the dining hall for both morning and afternoon exams.

2. Breakfast warm-up and early lunch for PM exams

3. Bags & Coats in WCR

4. Exams in the hall or rooms 19/20

1. Sign in here for AM exams

- Arrive before 8:30am

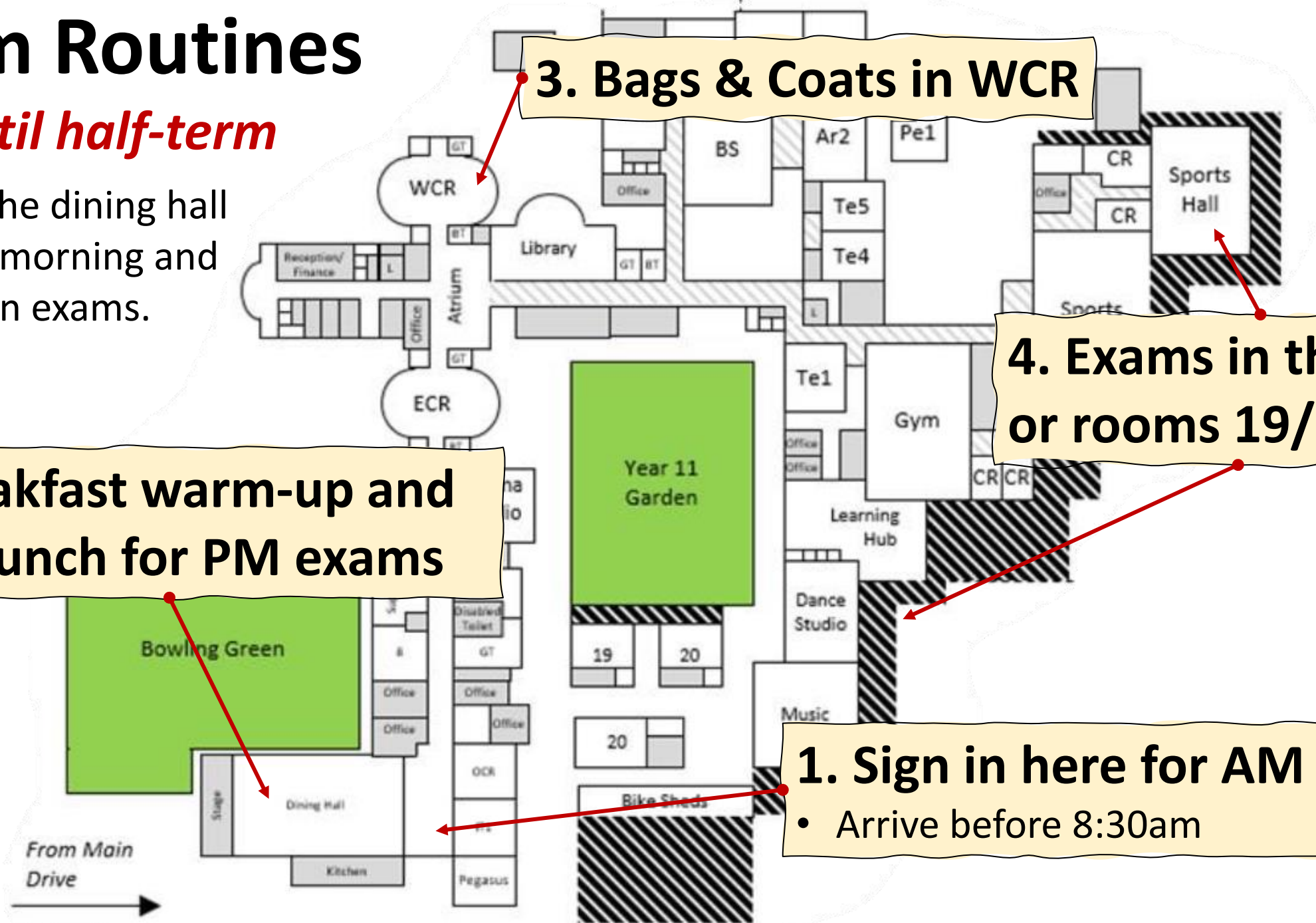

Leaver's Day - Celebration Event

1. **Form time** – English Language Breakfast Revision.

3. Final opportunity to be together as a **form** before a celebration **assembly** in the hall.

Friday 23 rd May	English Language Breakfast	English Language: Paper 1 (160) 1hr 45mins 08:45 – 10:30		Leaver's Assembly	Leaver's Afternoon	
		Exam	Exam			
	Form Time	Option A	Comb Sci + Triple + PSHE	Comb Sci + Triple + PSHE	Option D	PE + Triple + PSHE

3. **English Language Exam**

4. **Food, music and fun** on the back field.
Bring a picnic. Sign shirts. Take photos.

How is study leave going to work?

- Some students (<20) will be in school for **Guided Study**
 - Required attendance at guided revision sessions after some core exams.
 - Welcome at school every day.
 - Students and parents will be contacted.
- Most students are fully **Independent**.
 - Required in school only for your exams.
 - Welcome at school every day.
- Some ground rules.
 - Afternoon exams → Arrive by 12:30pm.
 - Morning exams → Arrive by 8:30am.
 - You must not leave the site and return during the school day. Once you're here, you need to stay. When you leave, you don't return that day.

Information Point

- Full exam timetable
- Seating plans for exams
- Revision resources

Revision Support

- Subject teachers will be available. Schedule on the way.

Dining Hall

- Breakfast warm-up sessions
- A relaxed study and social area throughout the day.

The Study Base

After half-term

The year 11 'zone'.

You must not be elsewhere in the school during lesson times.

Old Common Room

- A silent study area.

IT1

- A calm space with internet/PC access.

Entrance

- You *must* sign in/out here.

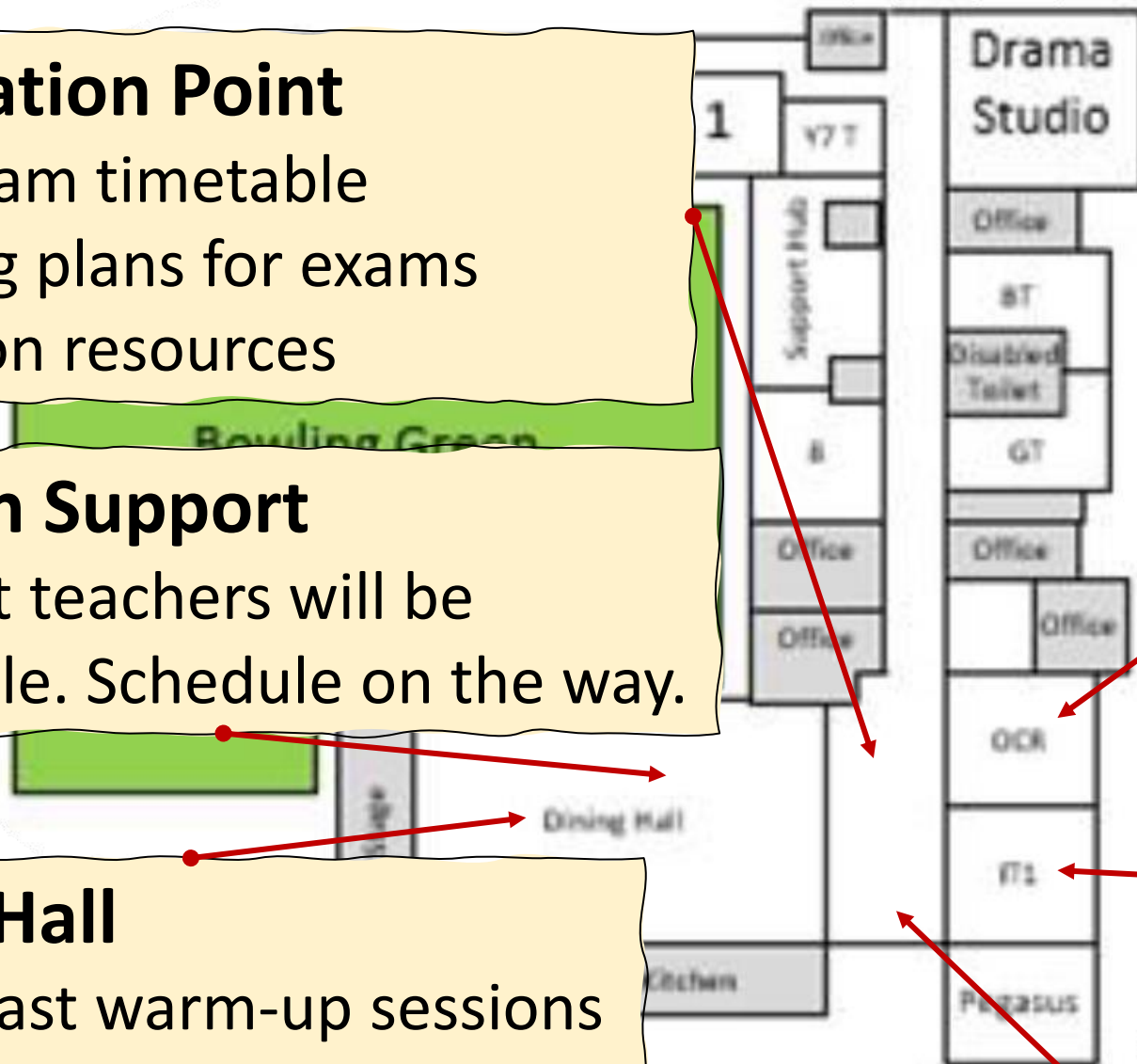

Exam Routines

After half-term

Start in the dining hall for both morning and afternoon exams.

2. Breakfast and lunch warm-up sessions

3. Bags & Coats in WCR

4. Exams in the hall or rooms 19/20

1. Sign in/out here

- Arrive before 8:30am and 12:30pm.

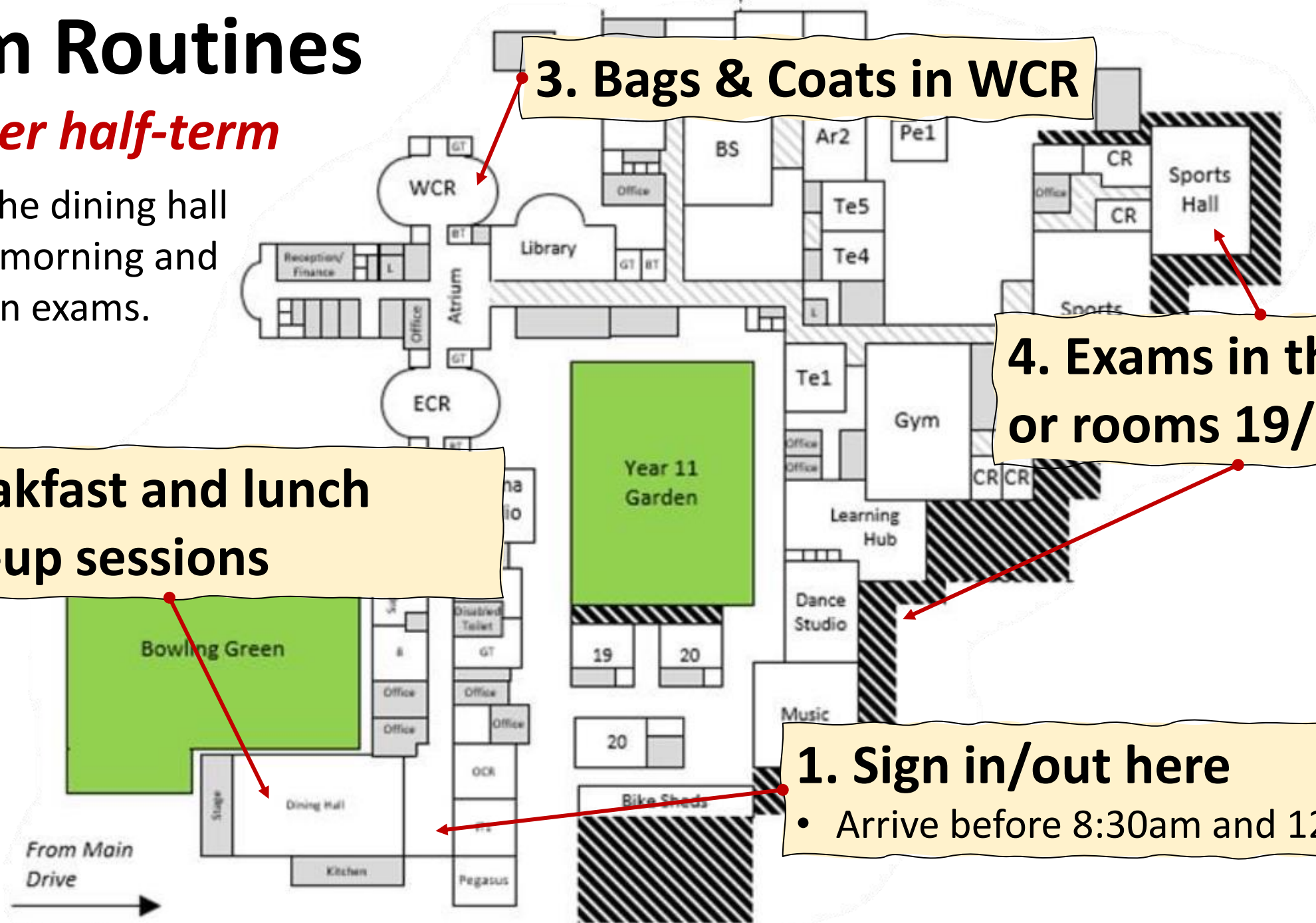

Final Reminders

School expectations have not changed

1. Wear your school uniform each day.
2. Be responsible around the college.
3. Be organised and be on time.
4. Remember exam rules and routines.
5. Phones cannot be seen or heard in school. No phones or watches in exams.
6. Come prepared:
 - Clear water bottle
 - Clear pencil case or plastic bag
 - All the necessary exam equipment →
 - Revision materials for use in revision lessons

Equipment

- Pens (more than one!)
- Pencils and rubber
- Ruler, Protractor, Compasses
- Calculator

Decisions about leaver's day, study leave and prom will be made in the fortnight after Easter. Make the right decisions to earn access to all three.